



ORIGINAL INSTRUCTIONS

for 200-85-KIT to upgrade the MAG-200 Series Dust Collector

This kit will work on all generations of the MAG-200



WARNING

NEVER ALTERNATE A MAG-200 BETWEEN A SHARPENER AND THE MAG-12008 BLADE CLEANER

SPARKS MAY IGNITE GRASS AND DEBRIS GENERATED BY THE MAG-12008 BLADE CLEANER

Box Contents for 200-85-KIT

- Shroud Frame
- Louvered Cover
- MERV8 12x12 pad filter
- MERV13 12x12x4 pleated filter
- Tube of silicone sealant
- Drill bit
- 6 self-tapping screws



QUICK START VIDEOS

SCAN ME



MAGNA-MATIC®

Installation Instructions

1. We strongly recommend using the **installation video**, scan the QR code for the Quick Start Videos.
2. **Unplug the MAG-200**
3. Remove the filter shroud that holds the 1" deep pleated filter (200-17). See Fig.1
4. Do this by removing the three self-tapping screws, one top, left, and right. See Fig.1
5. Next remove the 4 screws that hold the pad filter cover and remove the pad filter (200-15). See Fig.1
6. You will no longer need any of these parts removed. (screws could be saved as extras)
7. Clean the outer surface of the MAG-200 where you removed the old shroud. Later you will apply silicone and want to ensure good adhesion. See Fig.2
8. Take the 200-85-KIT shroud and remove the louvered cover and all of the filters so you are left with just the frame. See Fig.3

Fig.1

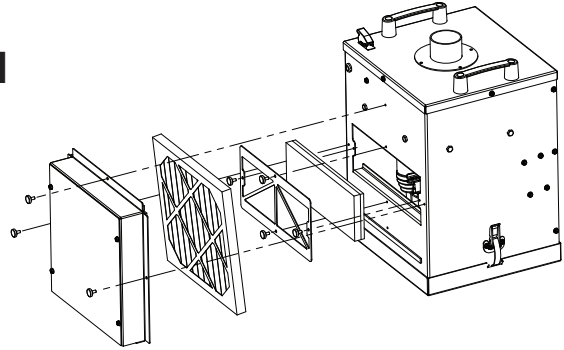

Fig.2

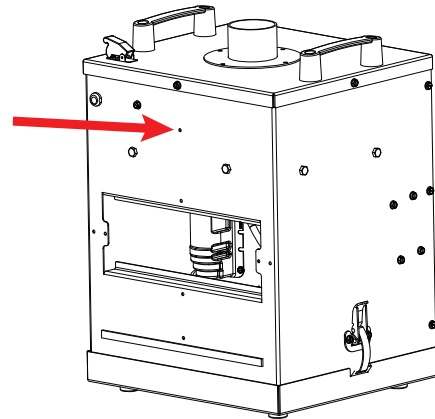
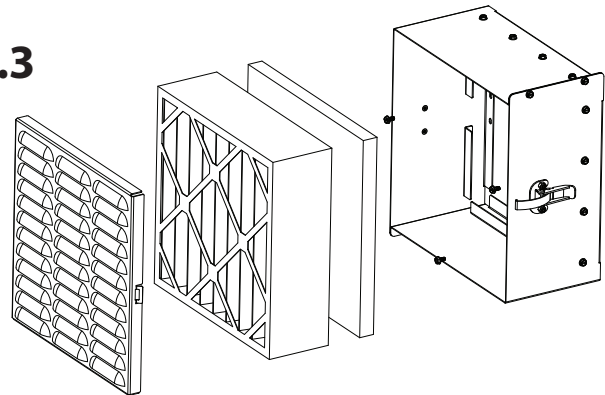
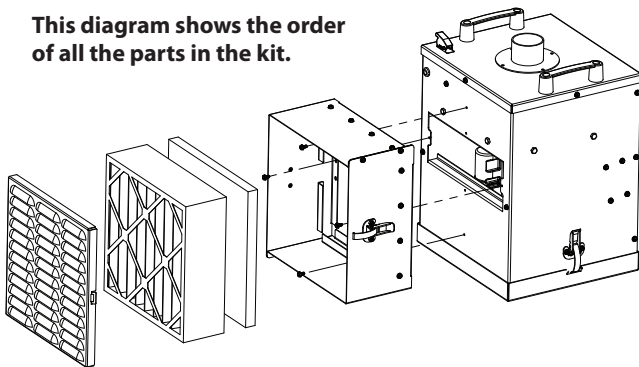

Fig.3



This diagram shows the order of all the parts in the kit.





ORIGINAL INSTRUCTIONS

for 200-85-KIT to upgrade the MAG-200 Series Dust Collector

This kit will work on all generations of the MAG-200

9. Apply silicone to the four tabs of the frame that will contact the MAG-200.
10. Locate the top hole and line it up with the top hole on the MAG-200 and start this screw, do not fully tighten it. See Fig.5
11. Next start the left and right side screws.
12. Now tighten all three screws. See Fig.5
13. Use the included drill bit to drill the fourth hole. Use the hole in the lower frame tab to locate the drill. See Fig.6
14. Drill the hole. See Fig.6
15. Use a self-tapping screw in the hole that you just drilled and tighten it.
16. Take the silicone and seal both the inside and outside seams of the filter frame to the MAG-200. Also seal the seams of the frame in the lower left and upper right corners. See Fig.7
17. Once the silicone has dried install the 200-80 pad filter 12x12 with the coarse side towards the inside.
18. Install the 200-81 pleated filter (4" deep) into the frame against the pad filter. The metal wires that support the pleated filter should face outward.
19. Place the louvered cover on the filter frame with the louvers pointed downward and connect it with the two clamps.
20. This completes the installation the MAG-200 is ready for use. See Fig.9

Fig.5

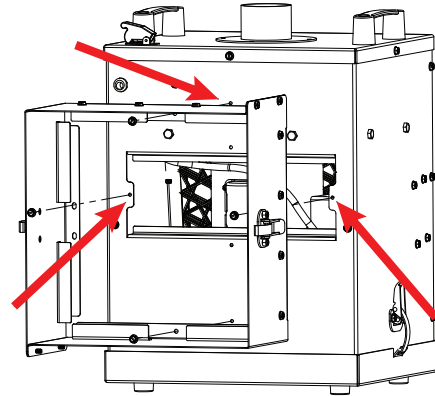

Fig.6

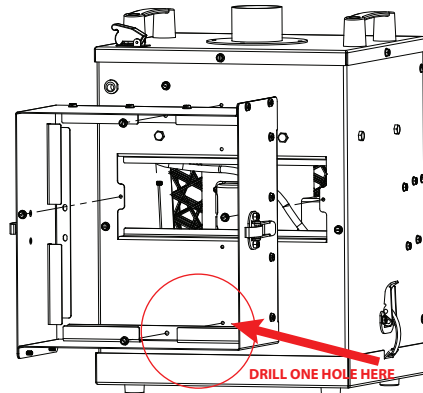

Fig.7

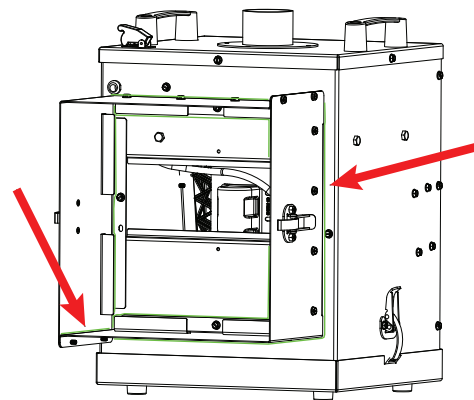

Fig.8

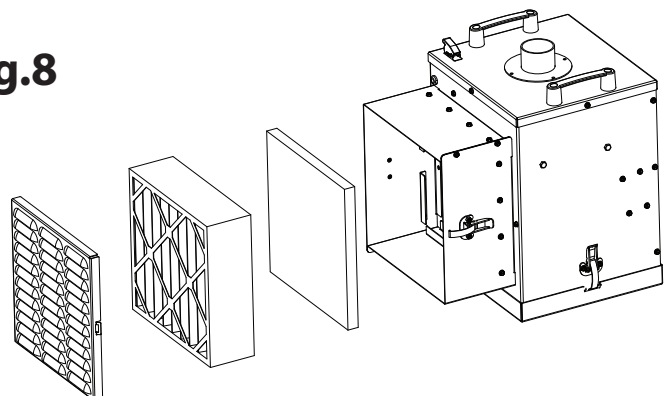

Fig.9

